

Promate[®] 300 Powerstation

Owner's Manual



QR code for linktr.ee/PromatePH

DOWNLOAD THIS MANUAL FROM www.promate.com.ph.

To ensure proper use, please read this manual and follow its instructions. Save this manual for future use.

INTRODUCTION

This Promate300 has been carefully engineered and manufactured to give you dependable operation. Please read this manual thoroughly before operating your new Promate300. Familiarize yourself with its features and optimize the performance that will bring you continued enjoyment for many years.

TABLE OF CONTENTS

I.	Important Safety Instructions	1
II.	Specifications	1
III.	Product Function	2-3
IV.	LCD Display	3-4
V.	Charging the Powerstation	4
VI.	Operating as a Power Supply	4-5
VII.	Troubleshooting	5
VIII.	Maintenance Instructions	6
IX.	Service Information	6-7
X.	What's in the Box	8
	Powerstation Exploded View and Part List	9

I. IMPORTANT SAFETY INSTRUCTIONS

1. To reduce the risk of injury, charge your Promate300 with the provided AC adaptor and charging cord. Other chargers may cause the battery to rupture, resulting in personal injury and property damage.
2. Promate chargers should NOT be exposed to rain or moisture.
3. The use of accessories not approved or sold by the manufacturer may result in fire, electric shock, or personal injury.
4. When removing the charger, tug on the cigarette lighter connector rather than the cord to prevent damage.
5. Make sure the cord is safe from being stepped on, tripped over, or otherwise subjected to damage or stress.
6. DO NOT use a charger with damaged cord or cigarette lighter connector - replace it immediately.
7. A service or repair technician authorized by Promate should be consulted before disassembling the Powerstation or its charger. A fire or electric shock could occur from improper handling.
8. Before doing any maintenance or cleaning, unplug the charger to prevent electric shock.
9. The Promate300 should always be oriented upright.
10. Keep it away from dust and dirt.
11. Warning –The Powerstation and its battery SHOULD NOT be exposed to fire or extreme heat since they have the potential to explode (read section II, #5 for operating temperature).
12. This unit meets the relevant safety requirements for the transport of dangerous goods.
13. When disposing of this unit, give careful consideration to both your safety and the environment.

Notes:

II. SPECIFICATIONS

1. GENERAL SPECIFICATIONS

- **Dimensions(mm):** 230 x 145 x 148mm
- **Net Weight(kg):** 3.5kg
- **Warranty:** This unit has a 1-year limited warranty from time of purchase.

2. OUTPUT PORTS

- **Wireless Charger:** 15W
- **DC and Car Outlet Output:** (DC 5521 Output (2) + car port output: Total 8A max.)
- **USB-A QC 3.0 Output x 2:** 5V \Rightarrow 2.5A, 9V \Rightarrow 2A, 12V \Rightarrow 2A (24W max.)
- **USB-C 65W Output x 2:** 5V/9V/12V/15V/20V \Rightarrow 3.2A (65W max.) Total 130W.
- **AC Output x 2:** Pure Sine Wave Power 230V-60Hz, total 300W rated, 600W surge.

3. INPUT PORTS

- **PV Input:** 18V-25V \Rightarrow 5A max/ 120W. DC 7909
- **AC Adapter Input x 1:** 20V \Rightarrow 6A, 120W. DC 7909
- **Car Charger Input:** 12V, 100W max.

4. BATTERY INFO

- **Powered By:** Promate
- **Cell:** Lithium-ion
- **Battery Cycle Life:** > 1000 times, remaining capacity > 80%.
- **Battery Capacity:** 265.7Wh 25.55V / 10.4 Ah

BMS Protections:

- High Temperature Protection
- Over Load Protection
- Over Voltage Protection
- Under Voltage Protection
- Overcharge Protection
- Overcurrent Protection
- Short Circuit Protection
- Over Discharge Protection

5. OPERATING TEMPERATURE

- **Discharging Temperature:** -10 to 40°Celsius
- **Charging Temperature:** 0 to 40°Celsius

III.PRODUCT FUNCTION

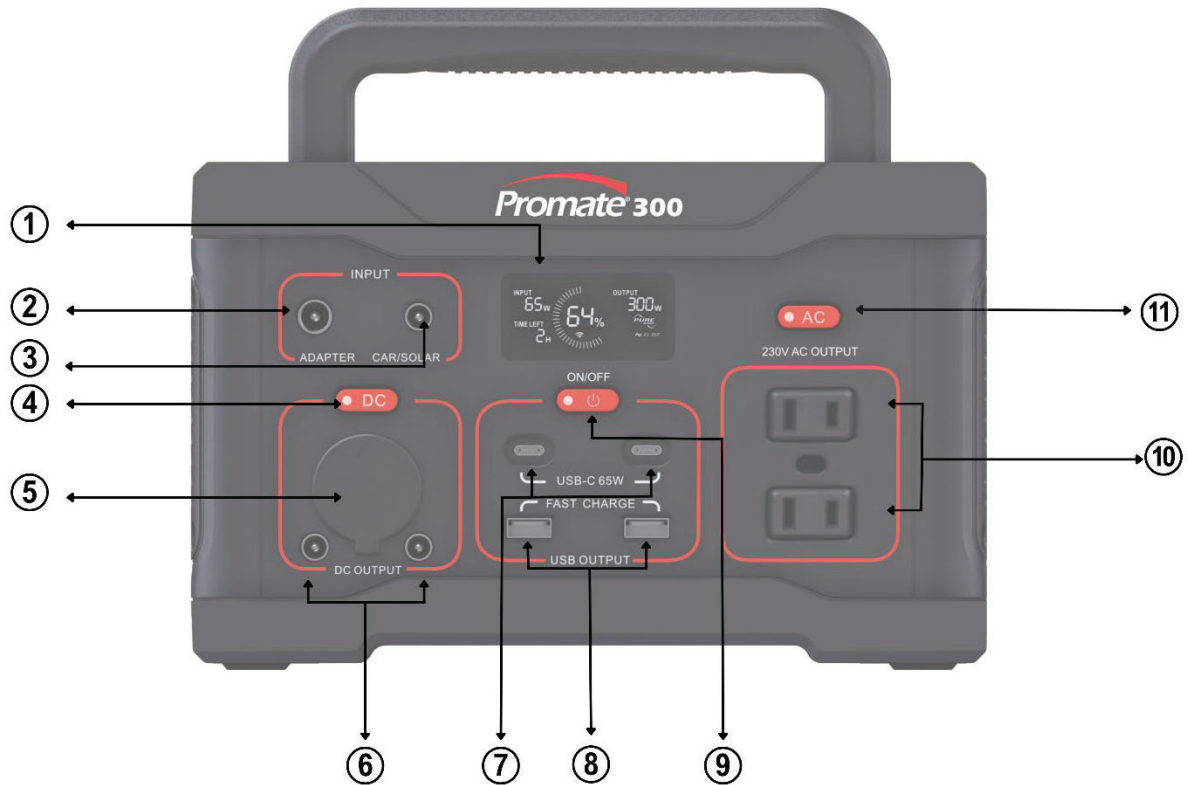

1. LCD Display

This displays the power and usage status of the unit.

2. Power Adapter Charging

Connect the Power Adaptor to this port and plug into the AC mains wall socket.

3. Car/Solar Input

It can handle solar power up to 120 watts and accept a maximum of 100 watts from car charging.

4. DC Output Switch

This button controls the product's car output and the two DC output ports.

5. Car Output

Total 8A max./ Cigarette lighter type

6. DC Output

Please do not attempt to use this as an input charger; it is only an output port.

7. USB-Type C 65-Watt PD Output (Power Delivery Technology)

8. USB-A QC 3.0 Fast Charging Output

9. Power On/Off Switch

Push the "power button" to turn on the unit. You can also turn on the USB charging mode. By double clicking the power button the unit will be placed in "sleep mode". To turn off the unit completely, press and hold the "power button" for approximately less than 3 seconds.

10. 230V AC Output

Charge or power up any device with a voltage requirement of 230V (< 300 watts total). Be careful not to overload the unit by exceeding the maximum continuous running power of 300 watts.

11. AC Output Switch

This button controls the product's AC output ports. To switch it "On/Off".

Notes:

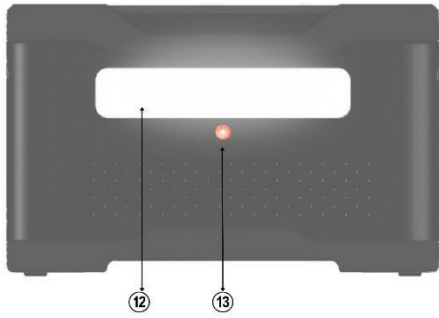

12. LED Light

The LED light comes with five modes: flash, SOS, and 3 brightness options (25, 50%, and 100%).

13. LED Light Button

Choose the mode of the LED light.

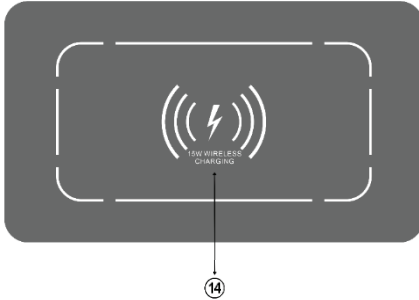

14. Wireless Charging

15W wireless charging function



15: Cooling Fan:

Cooling fan prevent the unit from overheating. Be careful not to block the air vents.

IV. LCD DISPLAY

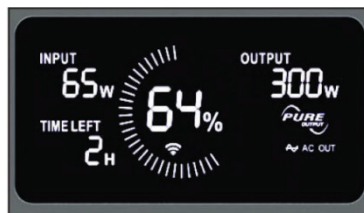

1. Input Current

Displays the actual current input power of the unit in watts.

2. Battery Level Indicator

Indicates how much battery is left. As the battery charges and discharges, the icon rotates.

3. Battery Charge Percentage

Display the remaining percentage of the battery. Try to charge the battery before it drops below 5%.

4. Output Current

Displays the actual current total output power of the unit in watts

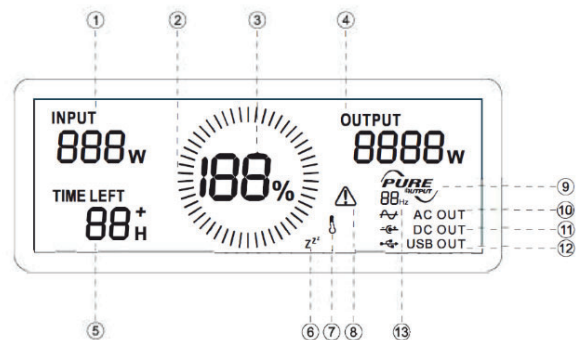

5. Remaining Charge/Discharge Time

The remaining charging/discharging time is based on the current power consumption of the unit.

6. Sleep Icon Z^z

The sleep icon will show up on the screen while the device is in sleep mode.

7. Temperature Protection

When the unit temperature is too high or too low, a temperature protection warning icon appears on the screen.

8. Warning

An alert icon shows up on the screen when there is an abnormal unit output.

9. Pure Sine Wave

The pure sinewave AC output icon appears on the screen when the AC output is being used.

10. AC Output Icon

When the AC output port is being used, the AC output icon appears on the screen.

11. DC Output Icon

When the DC output port is being used, the DC output icon appears on the screen.

12. USB Output Icon

When the USB output port is being used, the USB output icon appears on the screen.

13. Frequency Display Icon 88_{Hz}

The current frequency status shows the frequency of the AC output.

V. CHARGING THE POWERSTATION

Charge your Promate300 using the AC adapter after use. The LCD Screen will display the current charge. Once the LCD screen shows 100%, the Powerstation is full.

CHARGING WITH AC ADAPTOR

1. Use the AC adaptor provided with the powerstation. (72 watts)
2. This unit is designed to charge up to 80% in less than 3 hours, when using a single AC Power Charger. An additional 1 hour is required to charge the unit to 100%.

CHARGING WITH DC ADAPTOR

1. Use the car charger provided with the Powerstation.
2. Make sure to keep your car engine running while charging to avoid draining the car battery.

CHARGING WITH SOLAR PANEL

1. Select a solar panel 18V-25V / 120W max solar panel.
2. Connect solar panel in input ports common charging port (DC input).

VI. OPERATING AS A POWER SUPPLY

The Promate300 is capable of supplying power for 230V AC household devices and 12V DC devices up to the rated capacity of the unit. The length of time the product will operate depends on the condition of the battery and the current draw of the appliance. Low wattage appliances can be operated for several hours while higher wattage products will operate for less time.

230V AC SOCKET

1.1 Introduction

The Powerstation is equipped with a 300-Watt power inverter that converts the power from the internal battery to standard 230V AC household power. The Power Inverter supplies 300 watts of continuous power with 600 watts of surge power. When you turn on an appliance or a tool that operates using a motor or tubes, it requires an initial surge of power to start up. This surge of power is referred to as the “starting load” or “peak load”. Once started, the tool or appliance requires less power to continue to operate. This is referred to as the “continuous load” in terms of power requirements.

You will need to determine how much power your tool or appliance requires to start up and how much power it requires for continuous running. Power consumption is rated either in wattages (Watts) or in amperes (Amps). Multiply: Amps X 230 (AC Voltage) = Watts

This formula yields a close approximation of the continuous load of your appliances.

Multiply: Watts x 2 = Surge power

This formula yields a close approximation of the starting load of your appliances.

Most often the start-up load of the appliance or power tool determines whether the inverter has the capability to power it.

CAUTION:

Know the wattage requirement of your appliances. Use only those appliances that do not exceed the capacity of this unit.

1.2 Operating Instructions

Before using the inverter, ensure that the battery of your Powerstation is fully charged.

- Press the Power Button (9).
- Press the AC Button (11). The AC OUT logo  will appear.

If the AC product you are operating has a power switch, we recommend that it be put in the “OFF” position. Plug your product into the AC outlet and proceed to use according to the directions of the product.

The output power will show on the LCD as well as the indicative running time under the current load. The unit has an overload protection. The AC will automatically turn off in case of overload and the overload warning  logo will appear.

1.3 Operating with an Extension Cord

It is advised that you use an extension cord no longer than 30m between the AC appliance and the AC output. Less output could come from a longer cable.

USB/ PORT C

1. Press the Power button (9) On.
2. Connect the USB interface cable into the accessory and the Portable Powerstation USB port. This logo  USB will appear.
3. The output power will show on the LCD as well as the indicative running time under the current load.
4. Press Power button (9) Off after use.

WIRELESS CHARGER

NOTE: The Powerstation is equipped with 15W wireless charger for devices that have wireless charging capabilities.

1. Press the Power button (9) On to activate the wireless charger.
2. Put your device on top of the Powerstation.
3. Press Power button (9) Off after use.

DC JACK (DC5521)

The Powerstation is equipped with 2 x 13V DC jacks and can be used to operate 12V DC devices (maximum 5 Amps each).

1. Press the Power button (9).
2. Press DC button (4) On. The DC OUT logo  will appear.
3. The output power will show on the LCD as well as the indicative running time under the current load.
4. Press DC button (4) Off after use.

DC Cigarette Lighter port

The Powerstation is equipped with a 13V DC cigarette lighter type outlet and can be used to operate most 12V auto accessories and appliances (10 Amps maximum) equipped with a cigarette lighter plug.

1. Press the Power button (9).
2. Press DC button (4) On. The DC OUT logo  will appear.
3. The output power will show on the LCD as well as the indicative running time under the current load.
4. Press DC button (4) Off after use.

LED FLASHLIGHT

1. Press the Flashlight button (13).
The output power will show on the LCD as well as the indicative running time under the current load.

VII.TROUBLESHOOTING

a. Why is the LCD screen not lit up while the unit is charging?

Analysis: The LCD display turns off when the unit goes into standby mode.

Solution: The display will light up if you push the Power Button, AC Button or DC Button.

b. Why does the AC Power Supply heat up while charging?

Analysis: When using the AC Power Supply ensure that it is not exposed to excessive heat or direct sunlight. The operating temperature of this charger should be <70° C.

Solution: Charge at 0-40°C or replace with a new charger with the same specifications.

c. Why is the appliance not working when plugged into the AC port?

Analysis: This unit can support up to 300 watts of continuous power. Check if the appliances connected exceed the rated output power. If so, the overload protection will be triggered.

Solution: Remove all appliances connected to the unit. Switch the unit off and then on again. Check that the appliances you reconnect to the unit do not exceed 300 watts.

d. Why does the power switch off when using this unit in extremely high temperatures?

Analysis: This unit is designed with over-heating protection and will automatically switch off if exposed to excessive/extremely high temperatures.

Solution: Immediately switch off the unit. Once it has cooled down, turn it back on. The recommended operating temperature is < 40° C.

AC Output Overload Protection

Solution: Normal operation will be resumed automatically after you remove the overloaded device and restart the product. Electrical appliances should be used within rated power.

Tips for Use:

- Ensure that all "On/Off" buttons are in the "Off" position when the unit is not in use for long periods of time.
- To maintain the batteries, ensure that you charge them at least once every 3 months.
- When using this unit, never cover the fan/vent. The fan is designed to keep this unit at the correct operating temperature.
- This unit is designed with an advanced 8 stage BMS (Battery Management System) which integrates overload, overheating, short circuit, overvoltage, under voltage and other safety protection technologies. When troubleshooting, turn the power switch "Off" and then back "On" it to reset the power supply.
- The LED Bar Light on the back of the unit has 3 brightness options, 25%/50%/100%. It also has an SOS and Flashing mode.

Recycling:

Please ensure that the used electronics, batteries, and packaging materials are recycled especially the lithium-ion batteries. Do not be irresponsible when disposing of these batteries.

Battery Information:

This unit has high quality ternary lithium-ion batteries. Do not disassemble the unit and remove the batteries. These batteries can be charged and discharged >1000 cycles.

Statement:

Please be aware that this manual is only for this unit Promate300 and does not represent the manual for the other models. In addition, this manual is provided as a guide only, the pictures in this manual are for reference only, and all statements, information and suggestions in this manual do not constitute any express or implied warranty.

VIII.MAINTENANCE INSTRUCTIONS

All batteries lose charge with time. AC recharge is recommended after every use or every three months when not in frequent use. Use the AC charger and charge for the recommended time.

If the unit gets dirty, gently clean the outer surfaces with a soft cloth moistened with a mild solution of water and detergent. Do not use solvents or other chemical cleaners. Periodically check the condition of charging adapters, connectors, and wires. Do not open or disassemble. All other servicing should be performed by a qualified service technician only.

IX.SERVICE INFORMATION

HOW TO ORDER REPLACEMENT PARTS

Even quality-built equipment such as the powerstation you have purchased will need occasional replacement parts to maintain its good condition over the years.

To order replacement parts and consumable parts, please contact Promate Service (page 7) and be ready with the following information:

1. Model No., Serial No. and all specifications that are shown on the Model No./Serial No. plate.
2. Part number or numbers as shown in the Parts List section (page 9).
3. A brief description of the trouble with the powerstation

LIMITED WARRANTY

Warranty Coverage:

Powertech Asia Pacific Inc., (the Company) warrants to the original retail customer that it will repair or replace, free of charge, any parts found by the Company or its authorized service representative to be defective in material or workmanship. This warranty covers the cost of replacement parts and labor for defects in material or workmanship.

Not Covered:

- a. Shipping/Handling charges for sending the product to the Company or its authorized service representative for warranty service. Shipping/Handling repaired or replaced products back to the customer; these charges must be borne by the customer.
- b. If a separate operator's manual and engine warranty from the engine manufacturer is included with this product, only that warranty will apply to the engine.
- c. Damage caused by abuse, accident, the effects of corrosion, erosion and normal wear and tear.

- d. Warranty is void if the customer fails to install, maintain and operate the product in accordance with the instructions and recommendations of the Company set forth in the owner's manual, or if the product is used as rental equipment.
- e. The Company will not pay for repairs or adjustments to the product, or for any costs of labor performed without the Company's prior authorization.
- f. Consumable parts such as battery, spark plugs, and air cleaner

Warranty Period: One (1) year from the date of purchase on products used solely for consumer applications; if a product is used for business or commercial applications, the warranty period will be limited to ninety (90) days from the date of purchase. For warranty service, the customer must provide dated proof of purchase and must notify the Company within the warranty period.

EXCLUSIONS AND LIMITATIONS: THE COMPANY MAKES NO OTHER WARRANTY OF ANY KIND, EXPRESS OR IMPLIED. IMPLIED WARRANTIES, INCLUDING WARRANTIES OF MERCHANTABILITY AND OF FITNESS FOR A PARTICULAR PURPOSE, ARE HEREBY DISCLAIMED. THE WARRANTY SERVICE DESCRIBED ABOVE IS THE EXCLUSIVE REMEDY UNDER THIS WARRANTY; LIABILITY FOR INCIDENTAL AND CONSEQUENTIAL DAMAGES IS EXCLUDED TO THE EXTENT PERMITTED BY LAW.

This warranty gives you specific legal rights, and you may also have other rights which vary from state to state. Some states do not allow a disclaimer of implied warranties or the exclusion or limitation of incidental and consequential damages, so the above disclaimers and exclusions may not apply to you.



CONTACT THE POWERTECH Asia Pacific Inc.,
 PRODUCT SERVICE DEPARTMENT AT (02) 8 984 2620 | (+63) 9338373922
 service@powertechasiapacific.com www.facebook.com/PromateServicePH/

(MAIN) #420 Diamond Warehouse Compound, F Legaspi St., Maybunga Pasig City 1607
 (DAVAO) Space 10 & 11 Jin-Long Complex R. Castillo St., Agdao District, Davao City 800

X.WHAT'S IN THE BOX

No.	Item	Quantity
1	 <p>Promate300</p>	1
2	 <p>AC Power Charger</p>	1
3	 <p>Power Cable</p>	1
4	 <p>Solar Input Converter</p>	1
5	 <p>Car Charger Cable</p>	1
6	 <p>Operator's Manual</p>	1

POWERSTATION EXPLODED VERSION AND PART LIST

Model: Promate300

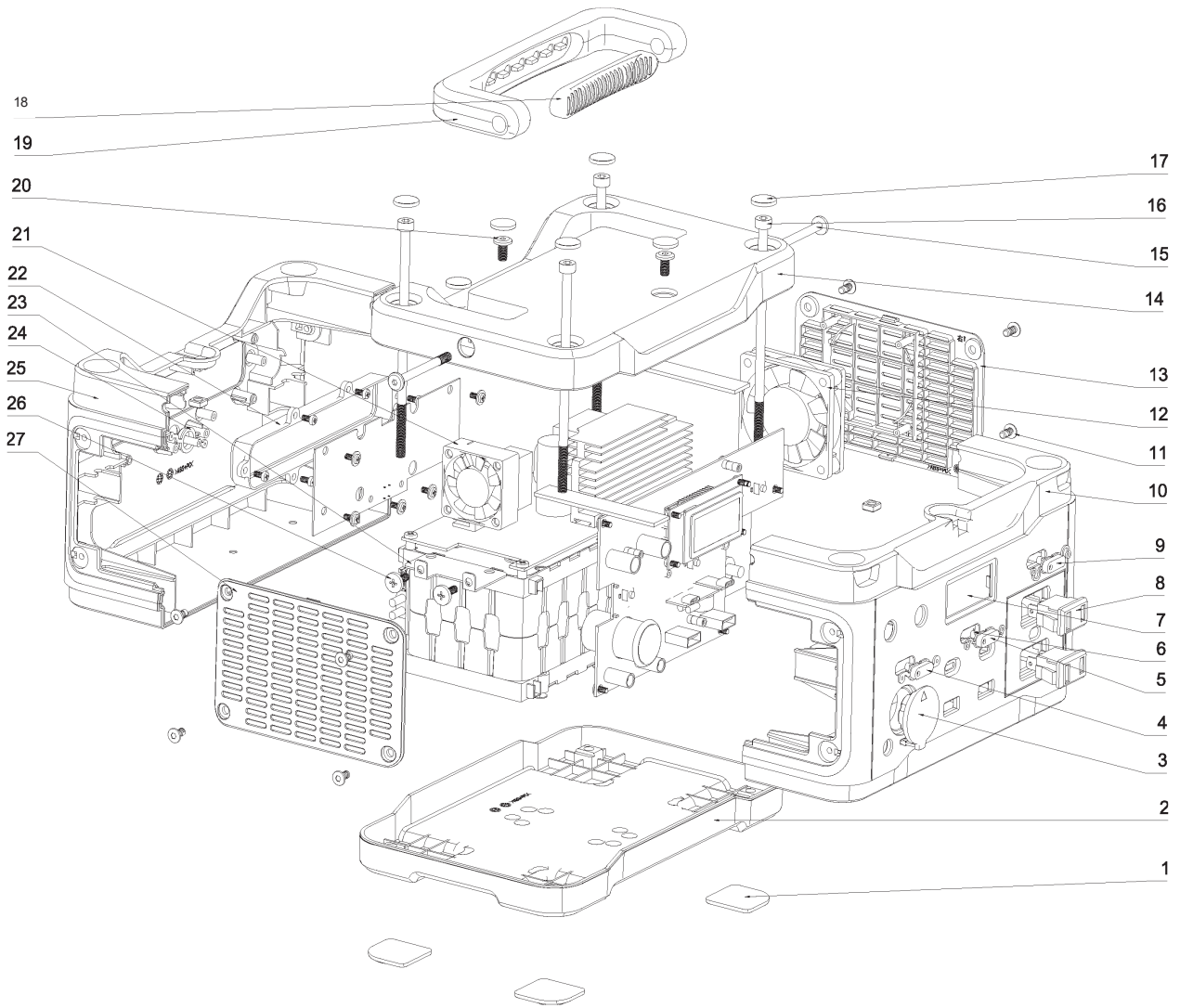

No.	Part Name	Unit	Qty
1	Rubber pad	PC	4
2	Bottom enclosure	PC	1
3	Protective cover	PC	1
4	DC output switch	PC	1
5	Power On/Off switch	PC	1
6	Light pipe	PC	3
7	LCD display	PC	1
8	230V AC output	PC	1
9	AC output switch	PC	2
10	Front panel	PC	1
11	Hexagonal self-tapping screws	PC	8
12	Speed regulating fan	PC	1
13	Right vent panel	PC	1
14	Up cover	PC	1
15	Hexagonal head cap screw	PC	2
16	Hexagonal head cap screw	PC	4
17	Rubber plate	PC	6
18	Handle rubber pad	PC	1
19	Handle	PC	1
20	Hexagonal head cap screw	PC	2
21	Speed regulating fan	PC	1
22	Light cover	PC	1
23	Fan fixing bracket	PC	1
24	LED light button switch	PC	1
25	Back panel	PC	1
26	Cross recessed self-tapping screws	PC	2
27	Left vent panel	PC	1